

Cooling Your Daily Life®



Ceiling installation



Floor installation

Design pressure

Refrigerant	Max working pressure
HFC*	24 bar
CO ₂	45-60 bar
Brine	10 bar

* Fluid group 2 according to EN 378

Each heat exchanger is leak tested with dry air and finally supplied with a dry air pre-charge. Fitted with schröder valve on the suction connection for testing purposes (only for HFC units).



CSX, LSX, CSB, LSB

Benefits

- Available for ceiling or floor installation
- Very low energy consumption
- Easy access to clean and maintenance
- Wide product range and accessories
- Two-year product guarantee

General information & application

CDX, CDB and LSX, LSB are high performance air coolers series from Aia LU-VE, for cold and freezing rooms. LSX, LSB series is optimized for installations in demanding environment. The coolers are supplied with a frame to be used for ceiling mounting. The same frame can be used for floor mounting installation.

Refrigerants

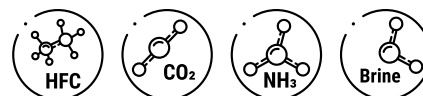

Capacity range (SC2 with R404)

7 up to 216 kW

Air quantity

7,400 up to 73,200 m³/h

Coil

The very high-efficiency TURBOCOIL® heat exchangers have the best power/cost ratio obtainable.

- High-efficiency TURBOFIN® aluminum fins with special configuration of the louvre profile to reduce dehumidification and frost formation.
- High-efficiency small-diameter copper tubes with internal helical grooving, designed for optimal evaporation of the new refrigerant fluids.

Standard fin spacings 4.5, 6, 7.5, 10 and 12 mm.

Casing

Corrosion-resistant galvanized steel casing with epoxy-polyester powder coating RAL 9003. Resistant against corrosion and easy to keep clean.

Fan motors

1 to 4 fans fitted with high-efficiency AC or EC fan motors with incorporated thermal protection. Available in 5 fan diameters (450, 500, 630, 710 and 800 mm) drawing through the coil.

TURBOFIN®

- CHS – TURBOFIN® 3 heat exchanger
Compact Surface heat exchanger with internally grooved tubes and staggered rows, suitable for both positive and negative temperature applications for the conservation of products with low humidity content, or packed products.
- LHS – TURBOFIN® 4 heat exchanger
Large Surface heat exchanger with internally grooved tubes and in-line rows, featuring a high ratio between the secondary fin surface and the primary tube surface, suitable for conservation cold rooms for products with high humidity content, and for freezing.



CSX, LSX, CSB, LSB

Commercial and industrial air coolers

Dimensions

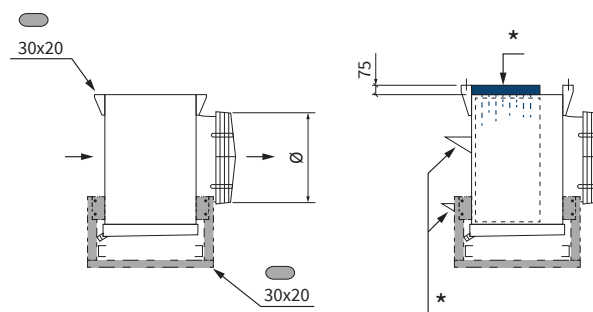
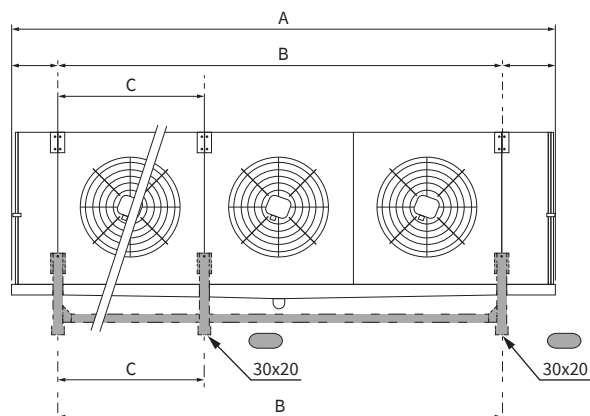

*only for SB (Water Spray Defrost)

Options

- Kit insulated rear air director cover
- Fan shroud heater
- Shut-up sock
- Textile tube adapter
- Insulated drain tray
- Unit cooler wirings
- Hinged fan shroud
- Fan switches
- Inox casing
- Feet kit evaporators

Selection

Selection and pricing is to be performed with our air heat exchanger selection software AiaCalc.

Selection output includes all relevant technical data and dimensional drawings.

Code description

CS	63	H	2214	E	6
1	2	3	4	5	6

- 1 CSX, LSX (CS=Compact Surface, LS=Large Surface) X air cooler
- 1 CSB, LSB (CS=Compact Surface, LS=Large Surface) Brine air cooler
- 2 Fan 45= Ø 450 mm, 50= Ø 500 mm, 63= Ø 630 mm, 71= Ø 710 mm, 80= Ø 800 mm
- 3 H=Hitec®
- 4 Model
- 5 N=Air defrost, E=Electric defrost, SB=Water spray defrost, G=Hot gas defrost for the coil and electric defrost for the drain tray, GB=Hot gas defrost for both coil and drain tray
- 6 Fin spacing: 4=4.5 mm, 6=6.0 mm, 7=7.5 mm, 10=10.0 mm, 12=12 mm
(Cold rooms: 4.5, 6.0, 7.5, 10 and 12 mm, Freezing rooms: 7.5, 10.0 and 12 mm)

Model (X, B air coolers)	n. of fans	Dimensions (mm)		
		A	B	C
CS - LS (Ø 450 mm)	1	1450	800	-
CS - LS (Ø 450 mm)	2	2250	1600	-
CS - LS (Ø 450 mm)	3	3050	2400	-
CS - LS (Ø 450 mm)	4	3850	3200	1600
CS - LS (Ø 500 mm)	1	1450	800	-
CS - LS (Ø 500 mm)	2	2250	1600	-
CS - LS (Ø 500 mm)	3	3050	2400	-
CS - LS (Ø 500 mm)	4	3850	3200	1600
CS - LS (Ø 630 mm)	1	1850	1200	-
CS - LS (Ø 630 mm)	2	3050	2400	-
CS - LS (Ø 630 mm)	3	4250	3600	1200
CS - LS (Ø 630 mm)	4	5450	4800	2400
CS - LS (Ø 710 mm)	1	1850	1200	-
CS - LS (Ø 710 mm)	2	3050	2400	-
CS - LS (Ø 710 mm)	3	4250	3600	1200
CS - LS (Ø 710 mm)	4	5450	4800	2400
CS - LS (Ø 800 mm)	1	1850	1200	-
CS - LS (Ø 800 mm)	2	3050	2400	-
CS - LS (Ø 800 mm)	3	4250	3600	1200
CS - LS (Ø 800 mm)	4	5450	4800	2400

Certifications

The Aia LU-VE quality system is in accordance with ISO 9001. All products are manufactured according to PED regulations. LU-VE Group participates in the ECP program for HE. Check ongoing validity of certificate*: www.eurovent-certification.com



31649597EN-00

*Ammonia and Brine refrigerants are not covered by Eurovent certification

Aia LU-VE is a trademark registered and owned by LU-VE Group.
Aia LU-VE reserves the right to change specifications without prior notification.

